

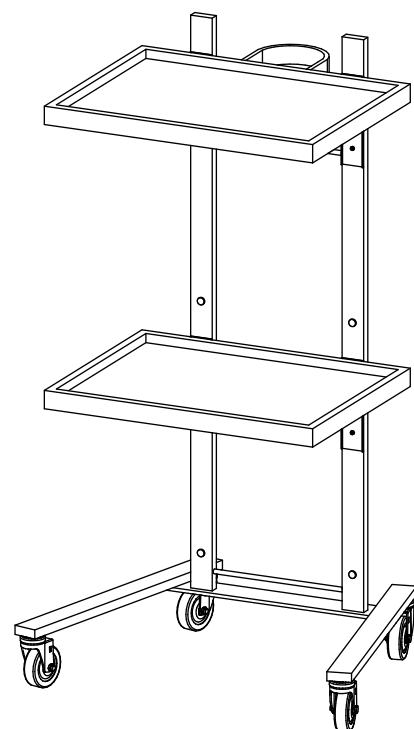

Kato Mobile Service Tray
Model # 4429

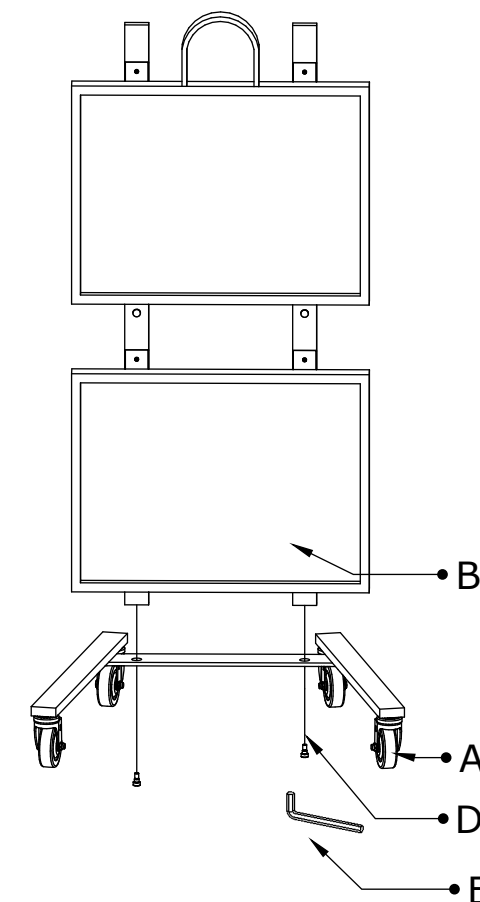

Assembly instructions:

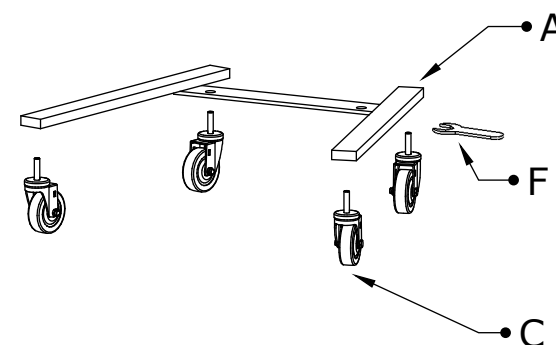

List of Parts for Assembly

Do not throw away packaging until after cart has been built and tested for proper use.

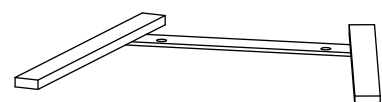

1 PC

PartA:Base

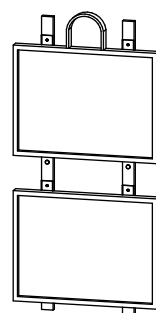

1 PC

PartB:TrayShelf



4 PC

PartC:Casters

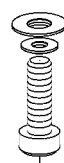

4 PC

PartD:Bolt/WasherSet



1 PC

PartE:AllenKey

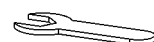

1 PC

PartF:Wrench

1

2

3

Assembly instructions:

1)Screw in Casters(C) to the bottom of the Base(A) until they are securely fastened
The Wrench(F) can be used to finish tightening the Casters to the Base..

2)Align the screw holes of the Base(A) and the threaded bottom of the Tray Shelf(B) supports. Tighten the Bolts/Washers Set(D) using the Allen Key(E) until it is secure.

3)Raise the tray up and lock into place.
You are now ready to enjoy many years of use out of your new Minerva Service Tray.

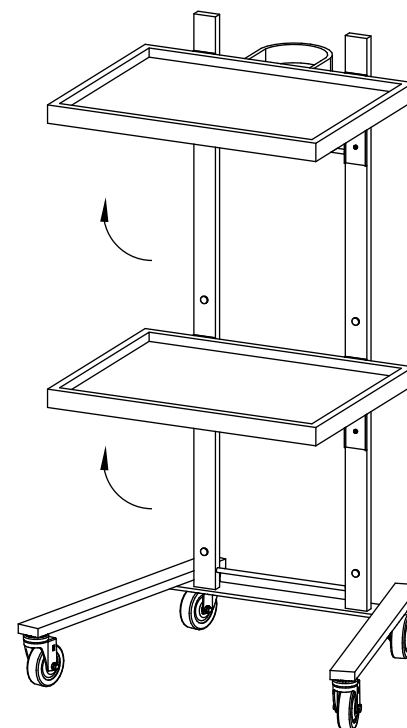

Designed by Minerva Beauty
Patent Pending